

Green Pin Super Bow Shackles with Safety Nut and Bolt Pin

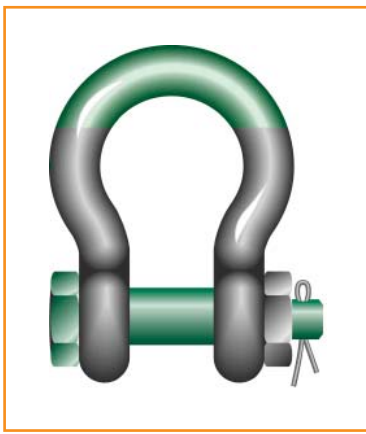

- Grade 8 Alloy steel body and pin, quenched and tempered.
- Minimum breaking load is 5 times the W.L.L.
- Meets performance requirements of US Fed Spec RRC - 271 Type IVA.
- Hot dipped galvanised finish(175ton shackle is painted).
- Marked with ID mark, size, W.L.L and manufacturers mark.

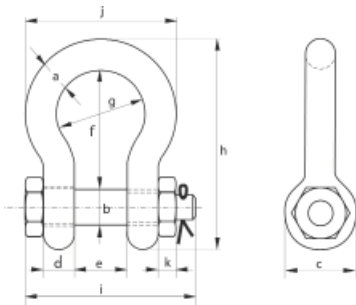

W.L.L tons	a mm	b mm	c mm	d mm	e mm	f mm	g mm	h mm	i mm	j mm	k mm	weight kgs
3.3	13.5	16	34	13.5	22	51	32	91	81	63	11	0.44
5	16	19	40	16	27	64	43	114	99	79	17	0.79
7	19	22	47	19	31	76	51	136	115	94	20	1.26
9.5	22	25	53	22	36	83	58	157	131	107	23	1.88
12.5	25	28	60	25	43	95	68	176	151	124	25	2.78
15	28	32	67	28	47	108	75	197	167	137	28	3.87
18	32	35	74	32	51	115	83	218	179	154	31	5.26
21	35	38	80	35	57	133	92	240	198	170	34	6.94
30	38	42	89	38	60	146	99	262	203	183	19	8.79
40	45	50	104	45	74	178	126	314	244	226	24	15
55	57	57	133	50	83	197	138	365	286	264	27	22.0
85	70	70	159	65	105	260	180	468	342	339	33	42.0
120	83	83	171	75	127	329	190	564	400	371	40	70.0
150*	95	95	215	89	144	381	238	667	440	416	50	112
175*	105	108	245	100	165	400	275	702	490	485	60	160

* = round headed bolt

Green Pin Wide Mouth Bow Shackles with Safety Nut and Bolt Pin

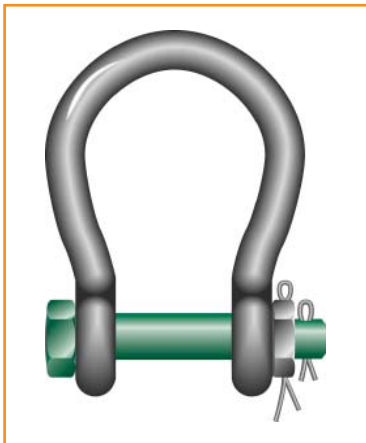

- Grade 8 Alloy steel bow and pin, quenched and tempered.
- Minimum breaking load is 6 times the W.L.L.
- Hot dipped galvanised finish.
- Meets performance requirements of US Fed Spec RRC - 271 Type IVA.
- Can be supplied with proof load certificate and/or material certificate.

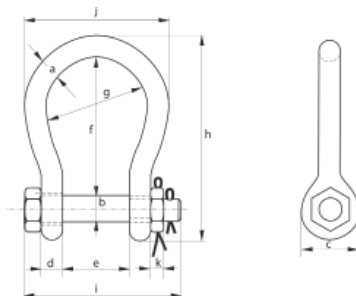

W.L.L tons	a mm	b mm	c mm	d mm	e mm	f mm	g mm	h mm	i mm	j mm	k mm	weight kgs
16	38	42	89	38	106	216	159	319	248	235	19	12.5
25	45	50	104	45	127	248	175	370	296	265	24	18
30	50	57	111	50	146	273	207	411	338	307	27	25
55	65	70	145	65	165	314	213	487	389	343	33	48
75	75	83	163	75	184	330	254	530	432	404	40	70



George Taylor & Company Lifting Gear (Midlands) Ltd. Brickyard Road, Aldridge, West Midlands WS9 8SR

Telephone: 01922 457916 or visit: www.gtlifting.co.uk

ALL OFFERS ARE SUBJECT TO OUR CONDITIONS OF BUSINESS