

Green Pin Standard Dee Shackles with Screw Collar Pin

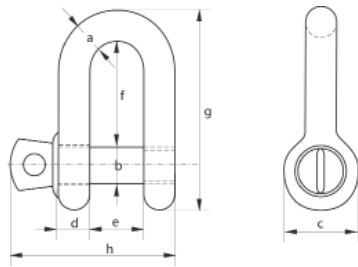

- Grade 6 high tensile steel, quenched and tempered.
- Minimum breaking load is 6 times the W.L.L.
- Conforms to EN 13889 and meets the performance requirements of US Fed Spec RC-C-271 Type IVA class 2, Grade A.
- Hot dipped galvanised.
- Temperature range -20 ° C upto +200 ° C.
- Supplied with proof load certificate, material certificate available on request.



W.L.L tons	a mm	b mm	c mm	d mm	e mm	f mm	g mm	h mm	weight kgs
0.33	5	6	12.5	5	9.5	19	38	31	0.02
0.5	7	8	17	7	12	22	47	40	0.05
0.75	9	10	21	9	13.5	26	56	49	0.09
1	10	11	23	10	17	32	66	56	0.14
1.5	11	13	26	11	19	37	74	68	0.19
2	13.5	16	34	13.5	22	43	85	76	0.32
3.25	16	19	40	16	27	51	105	93	0.54
4.75	19	22	47	19	31	59	125	107	0.87
6.5	22	25	53	22	36	73	144	123	1.34
8.5	25	28	60	25	43	85	161	141	2.08
9.5	28	32	67	28	47	90	179	158	2.77
12	32	35	74	32	51	94	199	176	3.72
13.5	35	38	80	35	57	115	220	192	5.14
17	38	42	89	38	60	127	239	208	6.85
25	45	50	104	45	74	149	283	250	11.45
35	50	57	111	50	83	171	333	281	16.86
42.5	57	65	134	57	95	190	360	321	24.61
55	65	70	145	65	105	203	399	355	32.65



George Taylor & Company Lifting Gear (Midlands) Ltd. Brickyard Road, Aldridge, West Midlands WS9 8SR

Telephone: 01922 457916 or visit: www.gtlifting.co.uk

ALL OFFERS ARE SUBJECT TO OUR CONDITIONS OF BUSINESS