

## Green Pin Polar Bow Shackles with Safety Nut and Bolt Pin

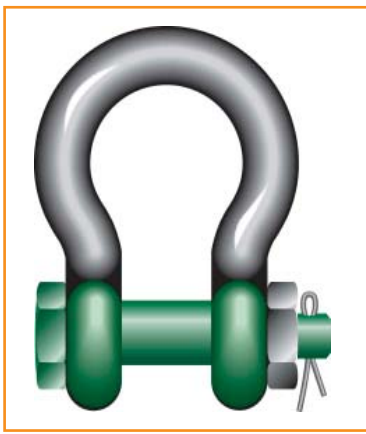

- For use in extreme climatic conditions.
- Grade 8 Alloy steel body and pin, quenched and tempered.
- Hot dipped galvanised finish.
- Temperature range from -40 ° C upto +200 ° C.
- Minimum breaking load is 8 times the W.L.L (except 55T and 85T where the M.B.L is 6 times the W.L.L).
- Meets the performance requirements of US Fed Spec RR-C-271 Type IVA Class 3 Grade B.
- Marked with ID mark, size, W.L.L and manufacturers mark.
- DNV Type Approved product certificate number S-4208.

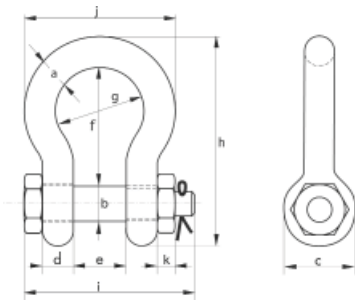

W.L.L tons	a inch	b inch	c inch	d inch	e inch	f inch	g inch	h inch	i inch	j inch	k inch	weight lbs
2	1/2	5/8	1 1/32	17/32	7/8	2	1 1/2	3 19/32	3 3/32	2 1/2	17/32	0.92
3.25	5/8	3/4	1 19/32	5/8	1 3/32	2 17/32	1 23/32	4 1/2	3 29/32	3 3/8	1 1/16	1.62
4.75	3/4	7/8	1 1/8	3/4	1 1/4	3	2	5 11/32	4 17/32	3 23/32	2 5/32	2.59
6.5	7/8	1	2 3/32	7/8	1 7/16	3 3/32	2 9/32	6 5/32	5 3/32	4 3/16	2 9/32	3.9
8.5	1	1 1/8	2 11/32	1	1 23/32	3 3/4	2 11/16	6 29/32	5 15/16	4 7/8	1	5.69
9.5	1 1/8	1 1/4	2 5/8	1 1/8	1 7/8	4 1/4	2 15/16	7 3/4	6 19/32	5 3/8	1 1/8	8.06
12	1 1/4	1 3/8	2 29/32	1 9/32	2	4 17/32	3 9/32	8 9/16	7 1/32	6 3/32	1 1/4	10.81
13.5	1 3/8	1 1/2	3 5/32	1 3/8	2 1/4	5 1/4	3 5/8	9 7/16	7 25/32	6 23/32	1 11/32	14.42
17	1 1/2	1 5/8	3 1/2	1 17/32	2 11/32	5 3/4	3 29/32	10 5/16	8	7 3/16	3/4	18.06
25	1 3/4	2	4 1/8	1 25/32	2 29/32	7	4 15/16	12 11/32	9 19/32	8 29/32	1 5/16	31.34
35	2	2 1/4	4 11/32	1 11/32	3 9/32	7 3/4	5 7/16	14 3/32	10 5/8	9 13/16	1 3/32	43.77
42.5	2 1/4	2 9/16	5 9/32	2 1/4	3 3/4	8 3/4	6 9/32	16 5/16	11 7/8	11 1/16	1 3/16	62.46
55	2 1/2	2 3/4	5 3/4	2 9/16	4 1/8	10 1/4	7 3/32	18 1/4	13	12 15/16	1 5/16	87.27
85	3	3 1/4	6 7/16	3 15/16	5	12 15/16	7 1/2	21 29/32	14 25/32	14	1 19/32	136.69

## Green Pin Heavy Duty Polar Bow Shackles with Safety Nut and Bolt Pin

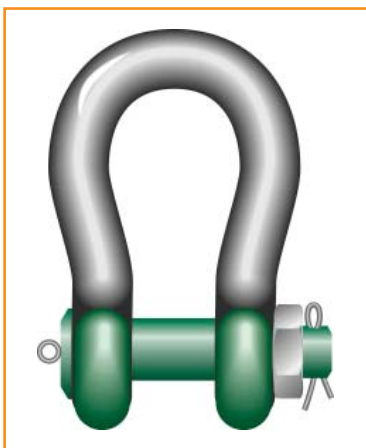

- For use in extreme climatic conditions.
- Grade 8 Alloy steel body and pin, quenched and tempered.
- Proof load certificate supplied - 120ton W.L.L.
- Lloyds Register of Shipping Proof Load Certificate supplied on 150ton W.L.L and above.
- Minimum breaking load 5 times the W.L.L.
- 120ton W.L.L - Hot dipped galvanised finish.
- 150ton W.L.L and above - silver painted body and green painted pin.
- Temperature range from -40 ° C upto +200 ° C.
- Marked with ID mark, size, W.L.L and manufacturers mark.

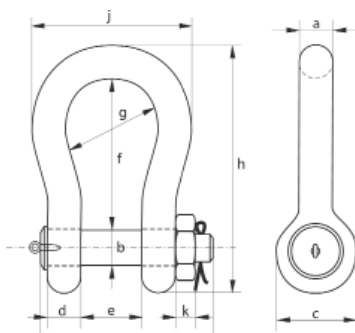

W.L.L tons	a mm	b mm	c mm	d mm	e mm	f mm	g mm	h mm	i mm	j mm	k mm	weight kg
120	95	95	215	89	144	381	238	667	440	416	50	110
150	105	108	245	100	165	400	275	702	490	485	60	160
200	120	130	288	110	175	500	290	854	520	530	60	235



George Taylor & Company Lifting Gear (Midlands) Ltd. Brickyard Road, Aldridge, West Midlands WS9 8SR

Telephone: 01922 457916 or visit: [www.gtlifting.co.uk](http://www.gtlifting.co.uk)

ALL OFFERS ARE SUBJECT TO OUR CONDITIONS OF BUSINESS