



# Instruction Manual

## Lever Hoist MK II



**NOTE:** Owner and operator must read and understand this instruction manual before using the Manual Hoist.

**George Taylor & Company Lifting Gear (Midlands) Ltd.**  
Brickyard Road, Aldridge, West Midlands WS9 8SR  
Telephone: 01922 457916 or visit: [www.gtlifting.co.uk](http://www.gtlifting.co.uk)

## APPLICATION & FEATURES

The lever hoist is a highly efficient and versatile tool for tightening goods, in power plants or for tightening telecommunication wires, as well as in factories, mines and construction-sites. It can be used for installing machines, lifting goods, dragging loads etc. It is particularly used in the narrow places, the open air and overload places for pulling and stretching work at almost any angle.

The main parts of the lever hoist are made of superior steel, which has the following characteristics in design and service:

1. Safe, reliable and durable in use.
2. Excellent performance, easy operation and minimum maintenance.
3. Small volume, lightweight and portable in size.
4. High efficiency, fast lifting and light hand pull.
5. Advanced structure and attractive appearance.

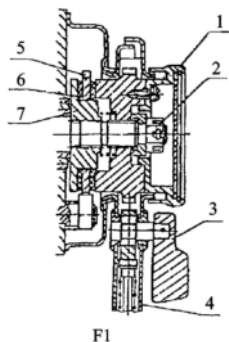

## CONSTRUCTION & OPERATION

The lever hoist is equipped with a “Free Brake” system which permits quick adjustment of the bottom hook when not loaded. Its main steps of operation are as follows:

### Quick reverse operation

Set the selector lever (3) to the “N” (neutral) position. Turn the hand wheel (1) counter-clockwise. When it stops, the brake is disengaged, thus allowing the load chain to be pulled by hand easily and the bottom hook to be adjusted to any desired position.

### Loading operation

Set the selector lever to the “UP” position. Turn the hand wheel clockwise. When it stops, the load chain is tightened and the brake is engaged, thus allowing the lever handle (4) to be operated by hand and the load to be lifted. Set the selector lever to the “DOWN” position and move the lever handle up and down, so that the load can be lowered and the work can be ended.

# OPERATION INSTRUCTIONS

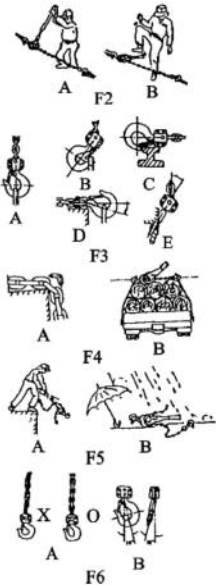

1. Do not overload. Do not use an extension on the lever (A, Fig. 2). Do not use a foot to apply pressure to the lever (B, Fig. 2).
2. Before working, inspect the hook to see whether it is securely attached. Centre loads on the bottom hook correctly (A, Fig. 3). The following illustrations show incorrect loading that needs to be avoided (B, C, D, E, Fig. 3).
3. Prevent the chain from dragging over sharp edges or corners (A, Fig. 3). When tightening goods in transport, the block must be applied along a straight line parallel to the surface it is resting on (B, Fig. 4).
4. No rough handling (A, Fig. 5). Do not expose to rainwater or excessive humidity (B, Fig. 5).
5. No twisting (A, Fig. 6). If the vertical angle at the neck of the top or bottom hook reaches  $10^{\circ}$  replace the hook (B, Fig. 6).

# MAINTENANCE

1. After use, clean off the dirt on the block and grease its parts. Keep it in a dry place.
2. Maintenance and inspection should be made by competent inspectors. Never allow any layman to disassemble or assemble the block.
3. While installing the castle nut (2), turn the hand wheel (1) clockwise, thus pressing the ratchet disk (5), friction disk (6) on the brake seat (7). Install the castle nut after turning (Fig. 1).
4. After cleaning and repairing, the block should be subjected to idle and heavy test so as to ensure reliability in use. Make sure that block is in good condition before putting it into operation.

# Lever Hoist 250 KG

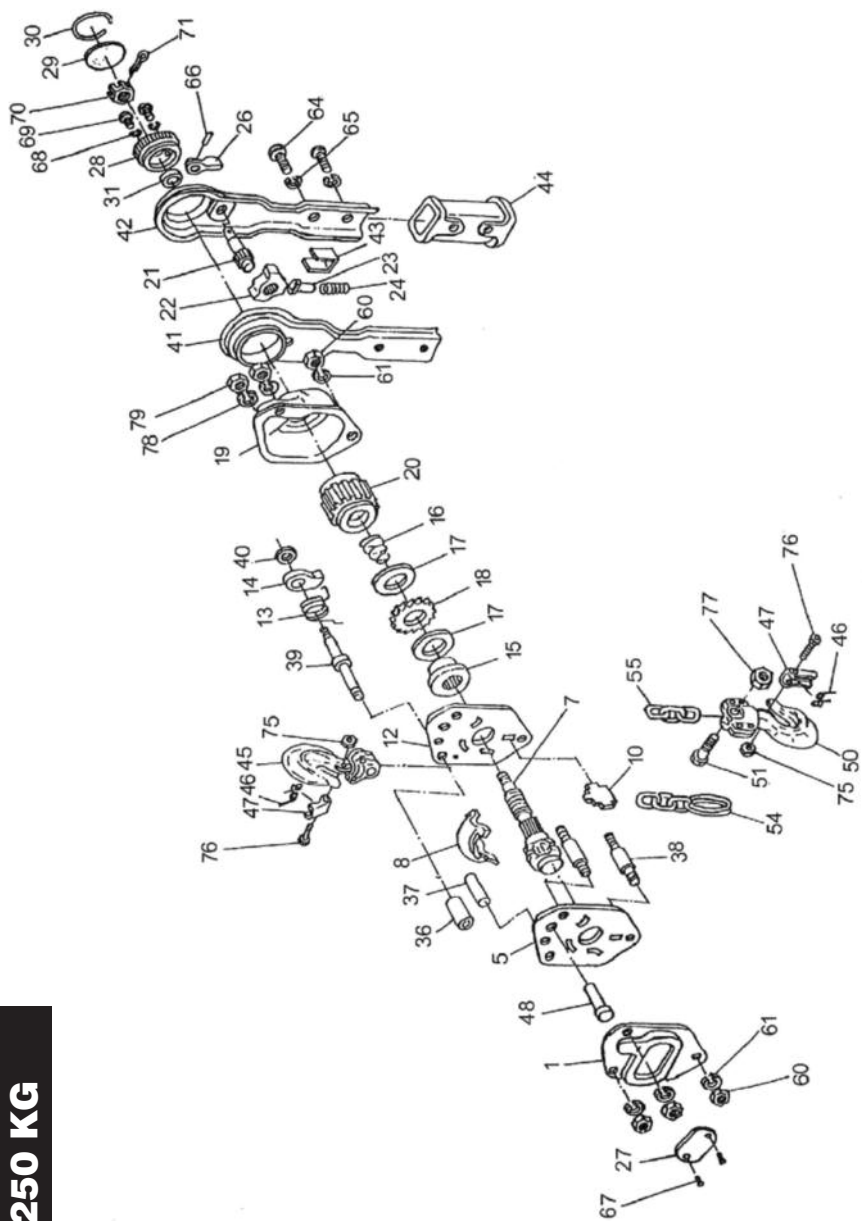

## Parts List for Lever Hoist 250KG

Part No	Description	Qty	Part No	Description	Qty
#1	Cover	1	#40	Washer	1
#5	Side plate A	1	#41	Lever handle assembly A	1
#7	Load Shaft	1	#42	Lever handle assembly B	1
#8	Guide plate	1	#43	Spring seat	1
#10	Stripper	1	#44	Handle rubber grip	1
#12	Side plate B	1	#45	Top hook assembly	1
#13	Pawl spring	1	#46	Double spring	2
#14	Pawl	1	#47	Safety latch	2
#15	Disk hub	1	#48	Top pin	1
#16	Free spring	1	#50	Bottom hook assembly	1
#17	Friction disk	2	#51	Chain pin	2
#18	Ratchet disk	1	#54	Chain ring	1
#19	Brake cover	1	#55	Load chain	1
#20	Change over gear	1	#60	Hexagon nut	5
#21	Selector Shaft	1	#61	Spring washer	5
#22	Change over pawl	1	#64	Screw	2
#23	Spring shaft	1	#65	Spring washer	2
#24	Change over spring	1	#66	Spring pin	1
#26	Selector lever	1	#67	Rivet	2
#27	Name plate	1	#68	Spring washer	3
#28	Hand Wheel	1	#69	Screw	3
#29	Indicator cap	1	#70	Castle nut	1
#30	Retainer wire	1	#71	Split pin	1
#31	Bushing	1	#75	Prevailing torque type nut	2
#36	Bushing	1	#76	Screw	2
#37	Special pin	1	#77	Prevailing torque type nut	1
#38	Stay bolt A	2	#78	Spring washer	1
#39	Stay bolt B	1	#79	Hexagon nut	1

### Note:

When ordering spare parts, please indicate part nos, and lever hoist capacity.

# Lever Hoist 500 KG

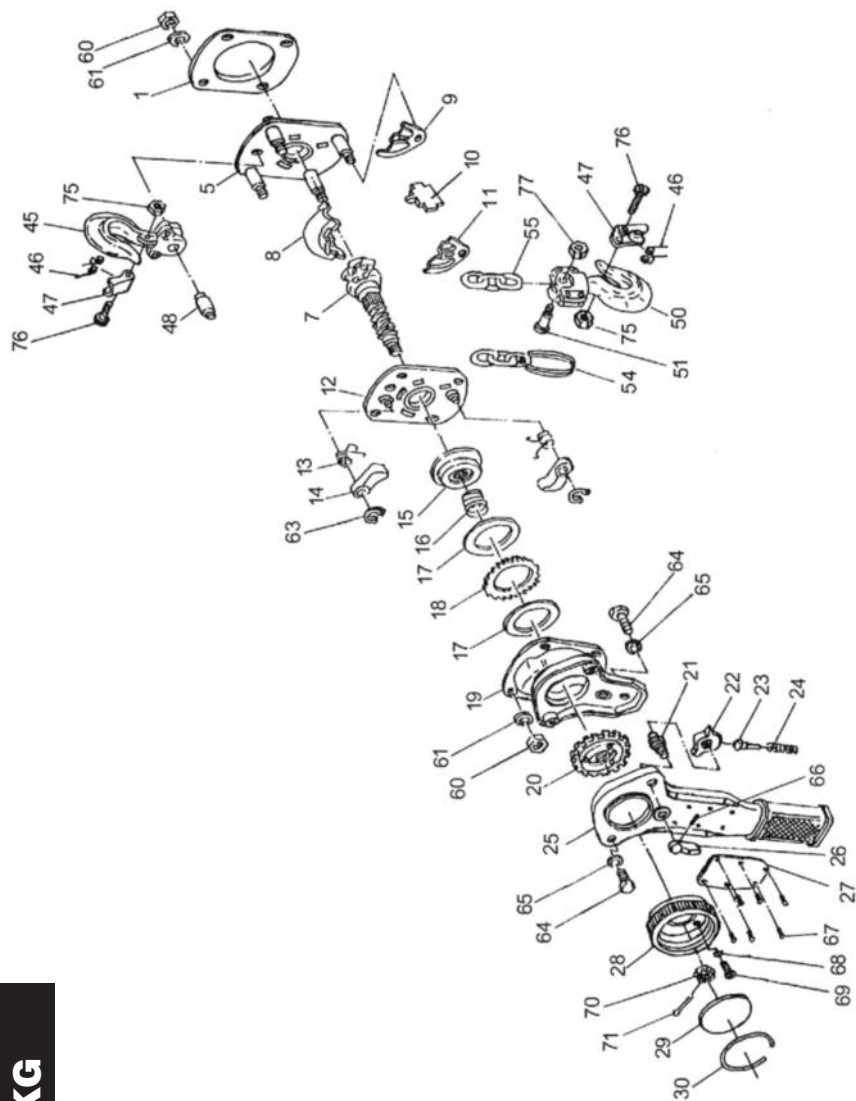

## Parts List for Lever Hoist 500KG

Part No	Description	Qty	Part No	Description	Qty
#1	Cover	1	#29	Indicator cap	1
#5	Side plate A	1	#30	Retainer wire	1
#7	Load Shaft	1	#45	Top hook assembly	1
#8	Guide plate	1	#46	Double spring	2
#9	Chain leader A	1	#47	Safety latch	2
#10	Stripper	1	#48	Top pin	1
#11	Chain leader B	1	#50	Bottom hook assembly	1
#12	Side plate B	1	#51	Chain pin	1
#13	Pawl spring	2	#54	Chain ring	1
#14	Pawl	2	#55	Load Chain	1
#15	Disk hub	1	#60	Hexagon nut	8
#16	Free spring	1	#61	Spring washer	8
#17	Friction disk	2	#63	Snap ring	2
#18	Ratchet disk	1	#64	Screw	3
#19	Brake cover assembly	1	#65	Spring washer	3
#20	Change over gear	1	#66	Spring pin	1
#21	Selector shaft	1	#67	Rivet	6
#22	Change over pawl	1	#68	Spring washer	3
#23	Spring shaft	1	#69	Screw	3
#24	Change over spring	1	#70	Castle nut	1
#25	Lever handle assembly	1	#71	Split pin	1
#26	Selector lever	1	#75	Prevailing torque type nut	2
#27	Name plate	1	#76	Screw	2
#28	Hand Wheel	1	#77	Prevailing torque type nut	1

### Note:

When ordering spare parts, please indicate part nos, and lever hoist capacity.

# Lever Hoist 750/1000/1500/3000/6000KG/9000KG

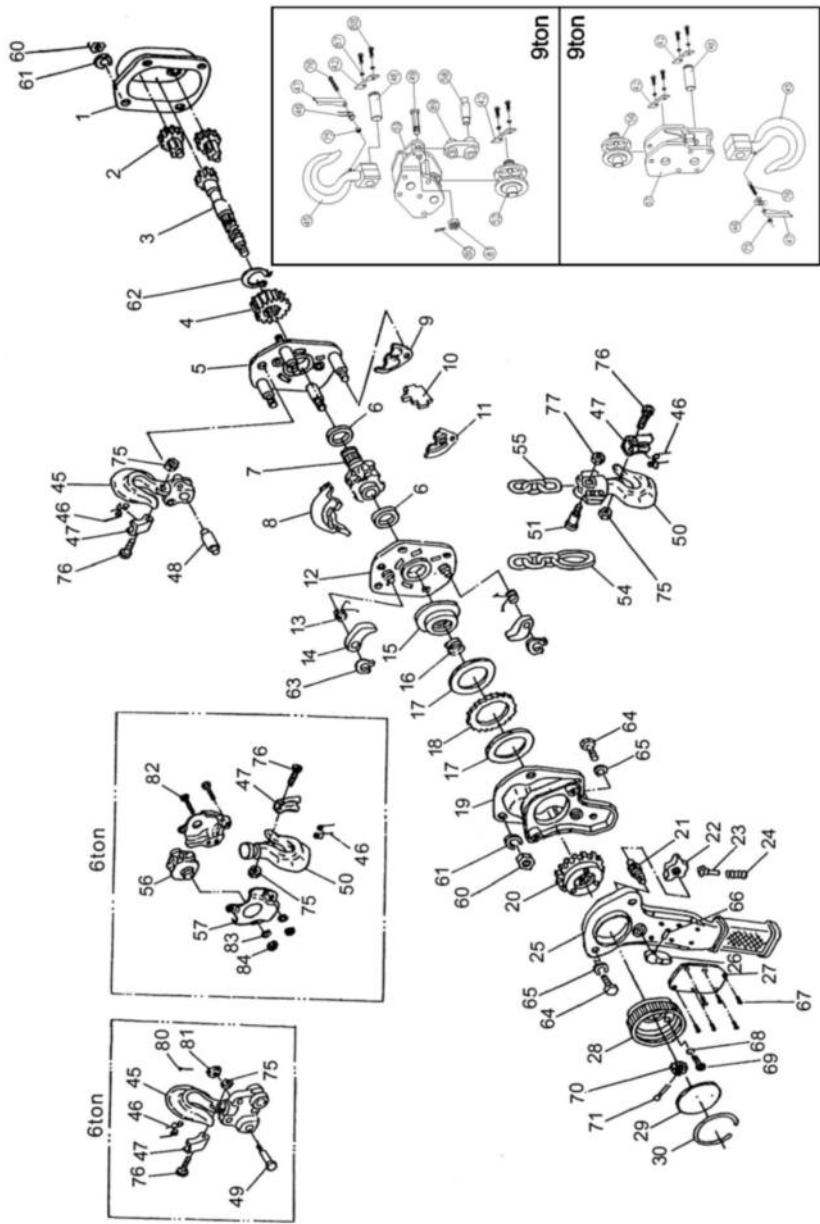

## Parts List for Lever Hoist 750/1000/1500/3000KG

Part No	Description	Qty	Part No	Description	Qty
#1	Gear case assembly	1			
#2	Driven shaft assembly	2	#28	Hand wheel	1
#3	Drive Shaft	1	#29	Indicator cap	1
#4	Splined gear	1	#30	Retainer wire	1
#5	Side plate A	1	#45	Top hook assembly	1
#6	Bushing	1	#46	Double spring	2
#7	Load sheave	1	#47	Safety latch	2
#8	Guide Plate	1	#48	Top pin	1
#9	Chain leader A	1	#50	Bottom hook assembly	1
#10	Stripper	1	#51	Chain pin	1
#11	Chain leader B	1	#54	Chain ring	1
#12	Side plate B	1	#55	Load chain	1
#13	Pawl spring	2	#60	Hexagon nut	8
#14	Pawl	2	#61	Spring washer	8
#15	Disk hub	1	#62	Snap ring	1
#16	Free spring	1	#63	Snap ring	2
#17	Friction disk	2	#64	Screw	3
#18	Ratchet disk	1	#65	Spring washer	3
#19	Brake cover assembly	1	#66	Spring pin	1
#20	Change over gear	1	#67	Rivet	6
#21	Selector Shaft	1	#68	Spring washer	3
#22	Change over pawl	1	#69	Screw	3
#23	Spring shaft	1	#70	Castle nut	1
#24	Change over spring	1	#71	Split pin	1
#25	Lever handle assembly	1	#75	Prevailing torque type nut	2
#26	Selector lever	1	#76	Screw	2
#27	Name plate	1	#77	Prevailing torque type nut	1

### Note:

When ordering spare parts, please indicate part nos, and lever hoist capacity.

## Parts List for Lever Hoist 6000KG/9000KG

Part No	Description	Qty	Part No	Description	Qty
#1	Gear case assembly	1	#47	Safety latch	2
#2	Driven shaft assembly	2	#48	Top pin	1
#3	Drive Shaft	1	#49	Chain pin	1
#4	Splined gear	1	#50	Bottom hook assembly	1
#5	Side plate A	1	#54	Chain ring	1
#6	Bushing	2	#55	Load chain	1
#7	Load sheave	1	#56	Idler sheave assembly	1
#8	Guide Plate	1	#57	Hook block component	2
#9	Chain leader A	1	#60	Hexagon nut	8
#10	Stripper	1	#61	Spring washer	8
#11	Chain leader B	1	#62	Snap ring	1
#12	Side plate B	1	#63	Snap ring	2
#13	Pawl spring	2	#64	Screw	3
#14	Pawl	2	#65	Spring washer	3
#15	Disk hub	1	#66	Spring pin	1
#16	Free spring	1	#67	Rivet	6
#17	Friction disk	2	#68	Spring washer	3
#18	Ratchet disk	1	#69	Screw	3
#19	Brake cover assembly	1	#70	Castle nut	1
#20	Change over gear	1	#71	Split pin	1
#21	Selector Shaft	1	#75	Prevailing torque type nut	2
#22	Change over pawl	1	#76	Screw	2
#23	Spring shaft	1	#80	Split pin	1
#24	Change over spring	1	#81	Castle nut	1
#25	Lever handle assembly	1	#82	Screw	5
#26	Selector lever	1	#83	Spring washer	5
#27	Name plate	1	#84	Hexagon nut	5
#28	Hand wheel	1	#42	Plate	3
#29	Indicator cap	1	#52	Upper idle sheave assembly	1
#30	Retainer wire	1	#87	Spring washer	6
#45	Top hook assembly	1	#88	Screw	6
#46	Double spring	2	#89	Hang plate	1

### Note:

When ordering spare parts, please indicate part nos, and lever hoist capacity.

# GT Lever Hoist MK II

1. Patent design of the driving shift mechanism.
2. High strength design of lever handle.

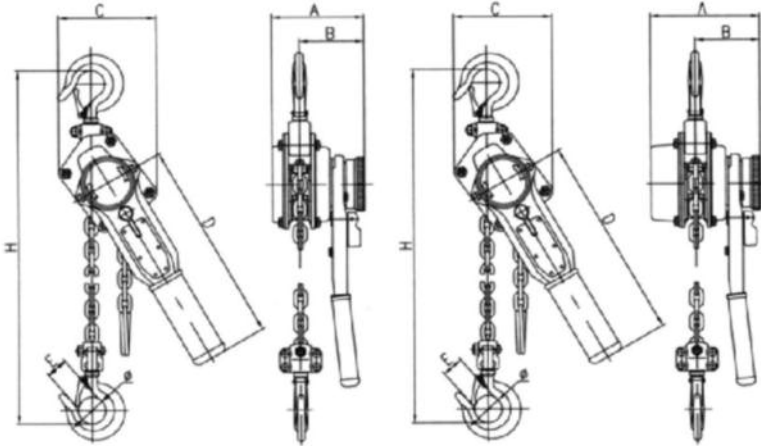

Model	Capacity load (kg)	Lifting height (m)	Test load (kg)	Force N (n)		Load chain		Min. Distance of two hooks (H mm)	Length of lever handle (D mm)		Dimensions (mm)					Net weight (kg)
				a	b	Number of falls	Diameter x Pitch		a	b	A	B	C	Ø	E	
SB050-C	500	1.5	750	350	315	1	5x15	310	278	308	110	84	125	35	27	5
SB075-C	750	1.5	1125	250	225	1	5.6x17	310	278	308	149	89	128	37	29	6.4
SB100-C	1000	1.5	1500	310	280	1	6x18	320	278	308	149	89	128	40	32	6.9
SB150-C	1500	1.5	2250	310	287	1	7x21	385	378	408	171	102	145	45	35	11.5
SB300-C	3000	1.5	4500	410	380	1	10x30	460	388	418	204	114	203	55	44	20.3
SB600-C	6000	1.5	7500	420	390	2	10x30	600	388	418	204	114	243	65	50	30.5
SB900-C	9000	1.5	11250	420	390	3	10x30	860	388	418	204	114	340	75	54	49.8



## **WARNING**

- Do not use to lift people or loads over people.
- Do not exceed the rated capacity of the lever hoist.
- Do not use lever hoist load chain as a sling, this may cause damage to the chain.
- Always inspect the lever hoist for damage prior to use. If lever hoist is damaged, do not use until it has been repaired or replaced.
- Do not use more load than marked on the lever hoist to lift or move a load.
- Do not use a lever hoist if the chain is twisted, kinked or damaged.
- Do not use a lever hoist unless load is centred between top and bottom hooks.
- Never use the lever hoist if either the hook is stretched, deformed, or has a broken or missing safety latch.

Distributor:

--